

The image contains two technical drawings of a wastewater treatment plant component, specifically a sludge pump system.

**SECTION 1 - 1**

This is a cross-sectional view of the sludge pump assembly. Key features include:

- Dimensions:** Overall width is 20000. Internal widths are 1850, 1000, 2000, and 1000. Vertical dimensions include 400, 200, 100, 600, 400, 200, 200, 1000, and 2600 Dia.
- Levels:** Weir Level 182.00, 182.70, 182.60, 181.90, 181.70, 181.90, 180.90, 180.50, 181.50, 181.85, 178.95, 178.10, 177.70, 176.05, 175.75, 178.85, and 179.90.
- Components:** Scraper assembly and fixed bridge, Diffusion Drum, 250 D.I. Feed pipe, 250 D.I. Liquor pipe, 450 D.I. Liquor pipe, EJ S2, Cj F7, 100 x 100 Splay, 100 Dia., 150/100 taper, 100 Dia., 1000, 3000, 1000, 200 Dia. Pipe to Sludge Drying Beds, Blank flange, 150/200 taper, 100/150 taper.
- Angles:** 7.5°, 22.5°, 30°.

**PLAN ON SLUDGE PUMPS**

This is a plan view of the sludge pump system. Key features include:

- Dimensions:** 5000, 1000, 1000, 1000, 1000, 500.
- Components:** 150 D.I. Sludge suction pipe, 100 Dia., 1000, 3000, 1000, 200 Dia. Pipe to Sludge Drying Beds, Blank flange, 150/200 taper, 100/150 taper.
- Angles:** 30°.

# SLUDGE DRYING BEDS

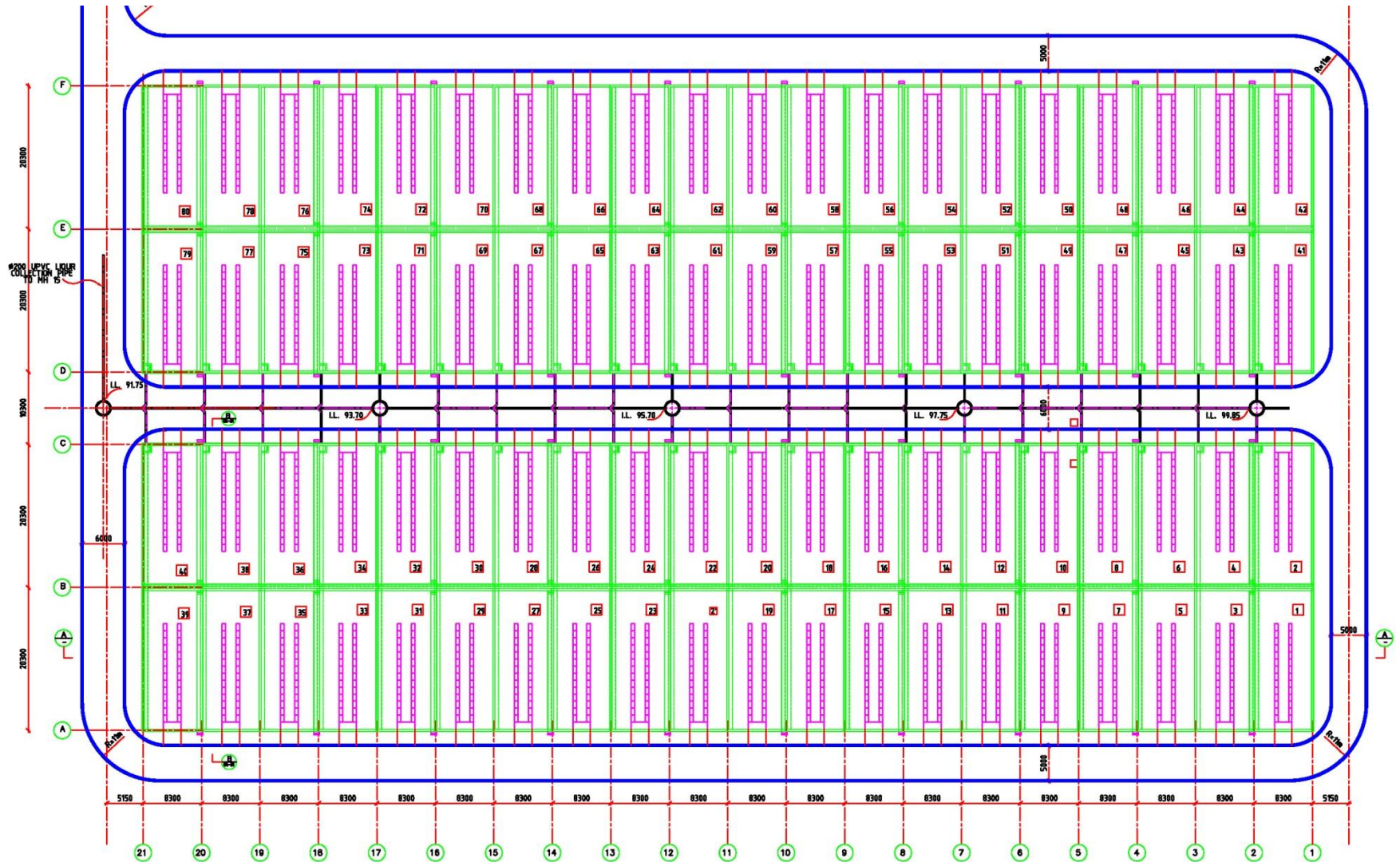

SLUDGE DRYING BEDS

# SLUDGE DRING BEDS





# DESIGN MISTAKES

## BAD SELECTION OF AERATION EQUIPMENT

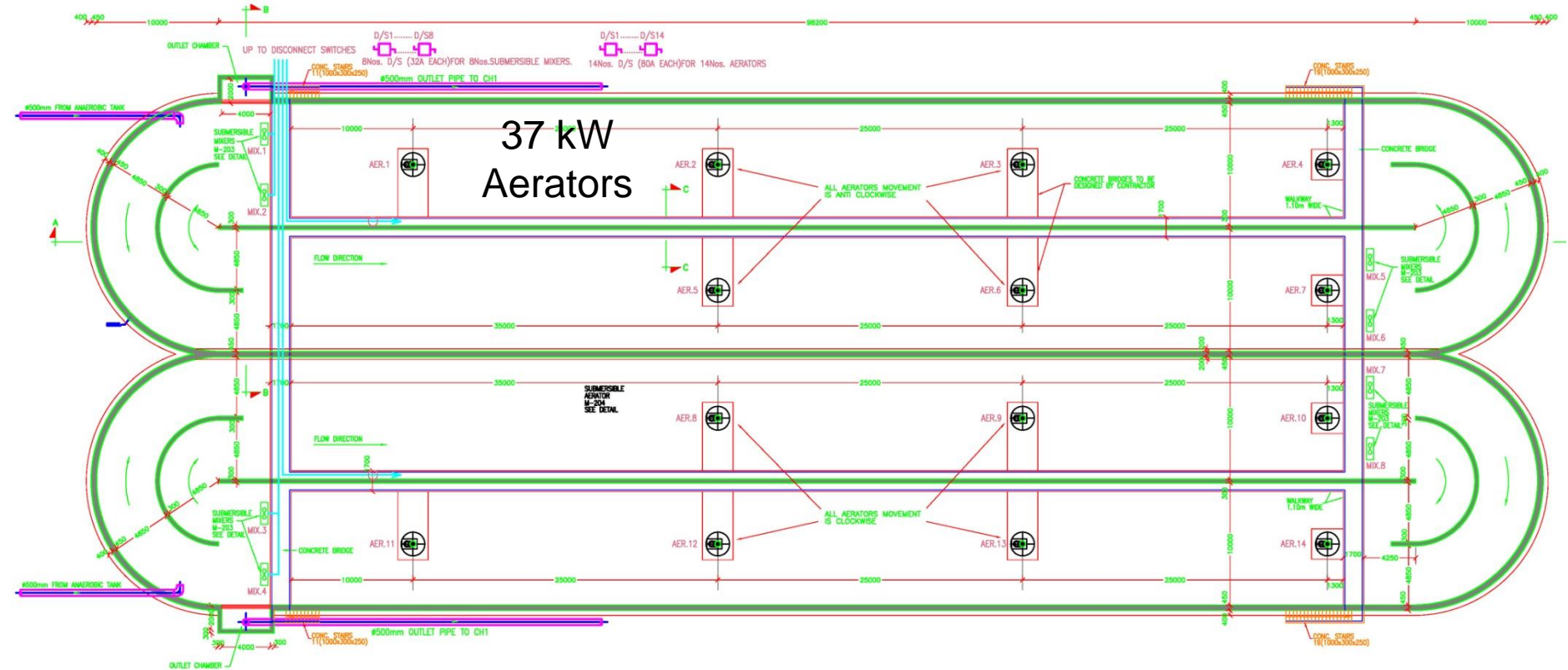

# DESIGN MISTAKES

## BAD LOCATION FOR MIXERS & LACK OF DIFFUSERS FREE ZONE

---

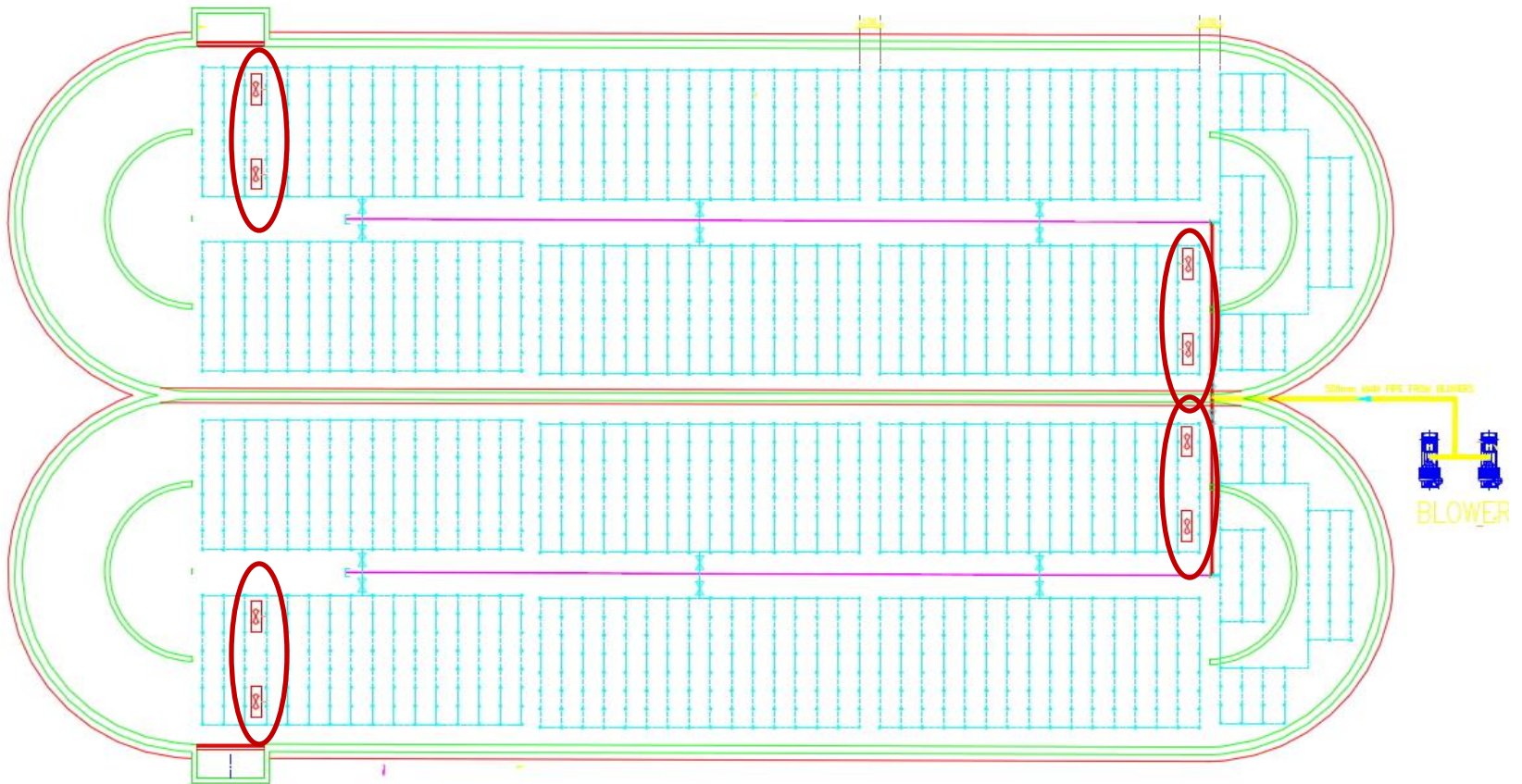

# AL-BIREH WWTP LAYOUT

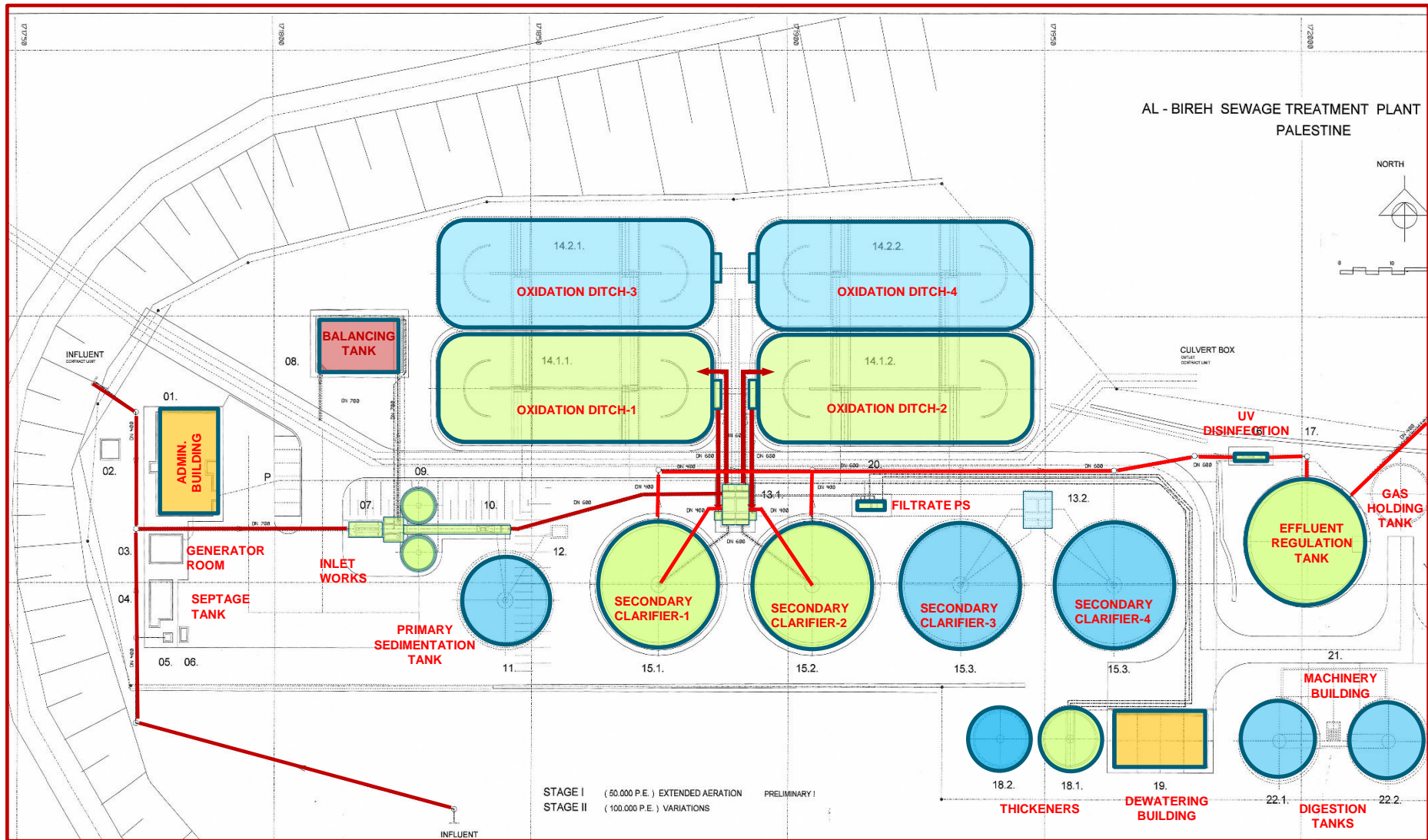



# AS-SAMRA WWTP LAYOUT

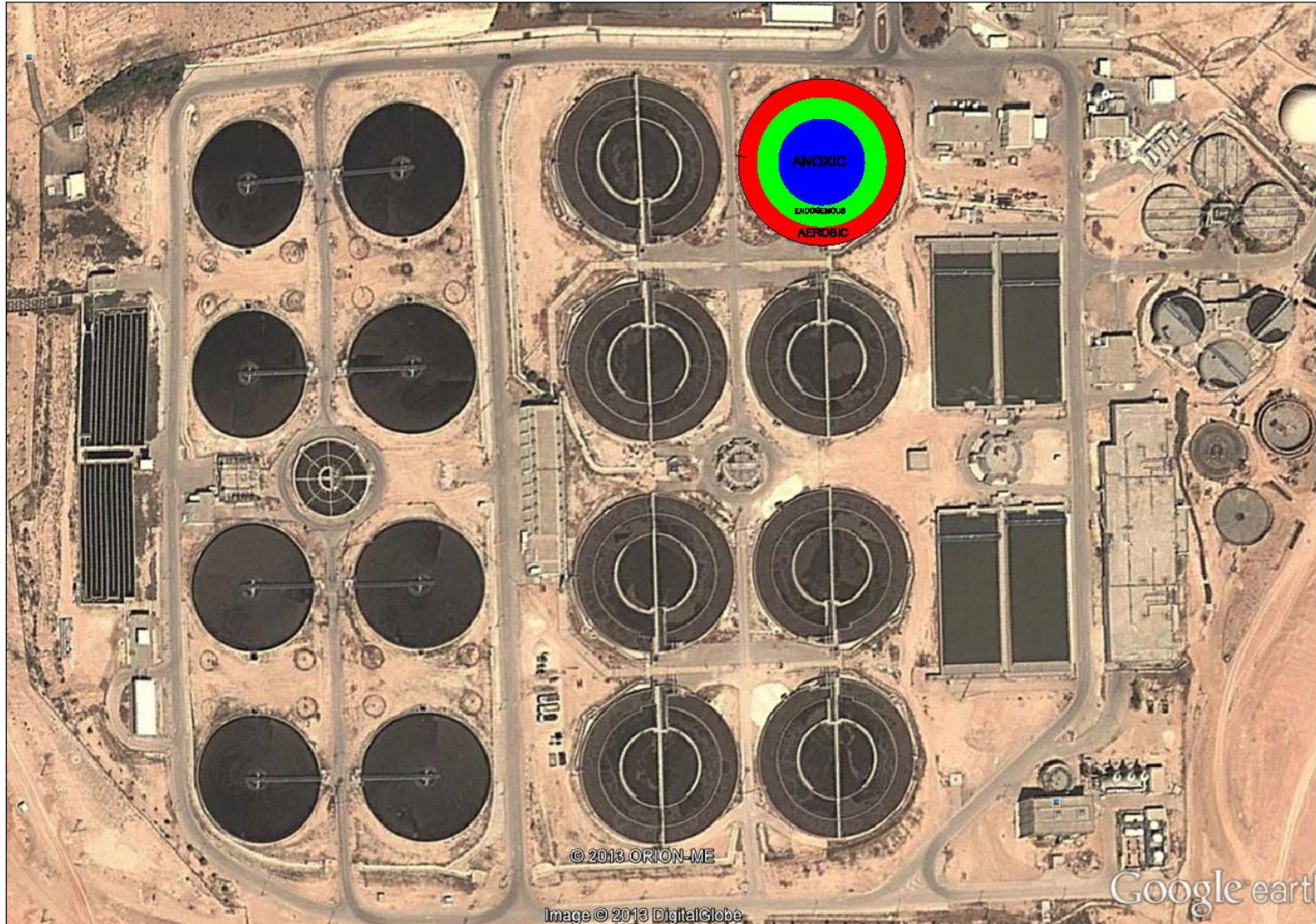

# AS-SAMRA WWTP BIOREACTOR CONFIGURATION

---

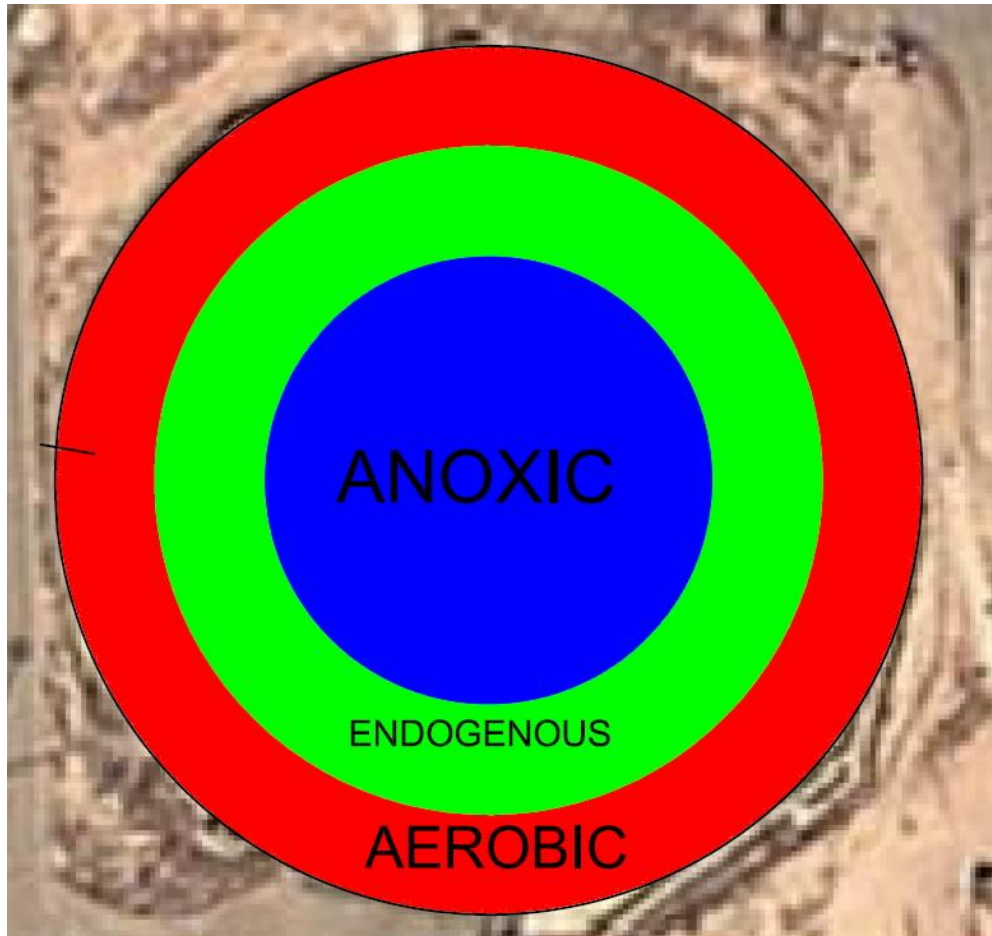



# SLUDGE DEWATERING

